



APMT Milling insert



Feature:

Strong edge, perfect abrasive resistance, high stability, wide cutting scope.
Performance exceed famous brand.

Application:

- M2: Stainless steel, Titanium alloy, Heat resisting alloy, Low-carbon steel.
- SS&PDTR: Steel, Cast iron.

		PVD			parameters	
		CP2630TN	CP1130FH	CP2430		
Material group	P Steel	✘		☉	120-160-250	
	P P20, 718, SKD11, S136H	✘		☉	100-130-160	
	P HRC40-63 Steel		☉		50-80-120	
	M Stainless steel	✘	☉	☉	60-110-150	
	K Cast iron	✘		✘	150-180-220	
	S Titanium alloy	✘		✘	40-60-80	
	S Heat-resisting steel	✘	☉	✘	40-60-100	
Type specification		Use			Ap(mm)	f (mm/ t)
APMT1135PDER-M2		Stainless steel			0.25-0.35	0.25-0.4
APMT1604PDER-M2		High temperature Titanium			0.3-0.6	0.3-0.6
APMT1135PDER-H2		Steel S50C,P20 718,738H Cast iron			0.20-0.35	0.25-0.4
APMT1604PDER-H2					0.30-0.60	0.3-0.6
APMT1135PDTR					0.20-0.35	0.3-0.5
APMT1605PDTR					0.40-0.70	0.5-0.8

CP2430 suitable for dry or air-cooled cutting





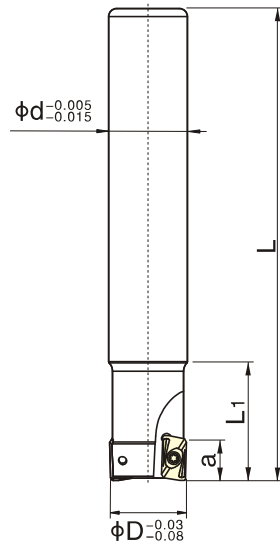

★ BAP endmills

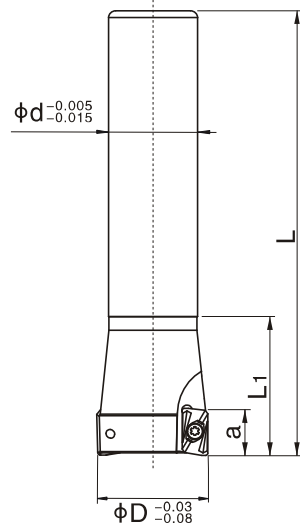

A type



B type

MODEL NO.	z	type	mm								inserts
			D	d	L	L1	L2				
BAP300R-10X120	1	A	10	10	120	30	-	MS2550	T8F T8		AP□□ 1135
BAP300R-12X120	1	A	12	12	120	30	-				
BAP300R-13X120-C12	1	B	13	12	120	30	-				
BAP300R-16X120	2	A	16	16	120	40	-	MS2560	T8F T8		AP□□ 1135
BAP300R-16X160	2	A	16	16	160	40	-				
BAP300R-17X160-C16	2	B	17	16	160	40	-				
BAP300R-20X120	3	A	20	20	120	40	-				
BAP300R-20X160	3	A	20	20	160	50	-				
BAP300R-21X120-C20	3	A	21	20	120	40	-				
BAP300R-21X160-C20	3	A	21	20	160	50	-				
BAP300R-25X160	3	A	25	25	160	50	-				
BAP300R-25X200	3	A	25	25	200	75	-				
BAP300R-30X160-C25	3	B	30	25	160	50	-				
BAP300R-30X200-C25	3	B	30	25	200	75	-	MS4090	T15F T15		AP□□ 1604
BAP400R-25X160	3	A	25	25	160	50	-				
BAP400R-25X200	3	A	25	25	200	75	-				
BAP400R-26X160-C25	3	B	26	25	160	50	-				
BAP400R-26X200-C25	3	B	26	25	200	50	-				
BAP400R-32X160-C25	3	B	32	25	160	50	-				
BAP400R-32X200-C25	3	B	32	25	200	50	-				
BAP400R-32X160	3	A	32	32	160	50	-				
BAP400R-32X200	3	A	32	32	200	80	-				
BAP400R-32X250	3	A	32	32	250	80	-				
BAP400R-35X160-C32	3	B	35	32	160	50	-				
BAP400R-35X200-C32	3	B	35	32	200	50	-				
BAP400R-35X250-C32	3	B	35	32	250	60	-				
BAP400R-40X160-C32	4	B	40	32	160	50	-				
BAP400R-40X200-C32	4	B	40	32	200	50	-				



★ BAP cutters

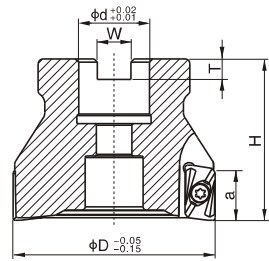

A type

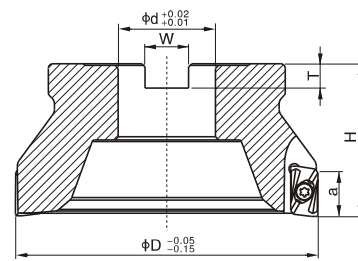

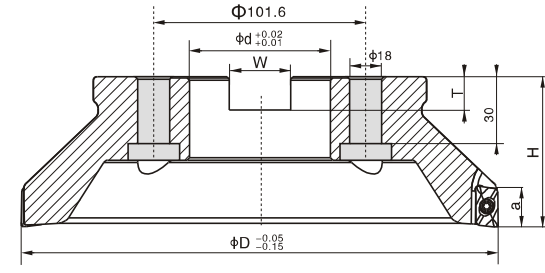

B type



C type



MODEL NO.	Z	type	mm								inserts
			D	d	H	W	T				
BAP300R-40-16	4	A	40	16	42	8.4	6.3	MS2560	T8F T8		AP□□1135
BAP300R-50-22	4	A	50	22	50	10.4	6.3				
BAP400R-50-22	4	A	50	22	50	10.4	6.3				
BAP400R-63-22	5	A	63	22	50	10.4	6.3	MS4090	T15F T15		AP□□1604
BAP400R-80-27	6	A	80	27	50	12.4	7				
BAP400R-100-32	6	B	100	32	50	14.4	8				
BAP400R-125-40	8	B	125	40	63	16.4	9				
BAP400R-160-40	9	B	160	40	63	16.4	9				
BAP400R-200-60	9	C	200	60	63	25.7	14				
BAP400R-50-25.4	4	A	50	25.4	50	10	6				
BAP400R-63-25.4	5	A	63	25.4	50	10	6				
BAP400R-80-25.4	6	A	80	25.4	50	12	6				



★ RAP

Use the other two edges of the APMT1604 insert.

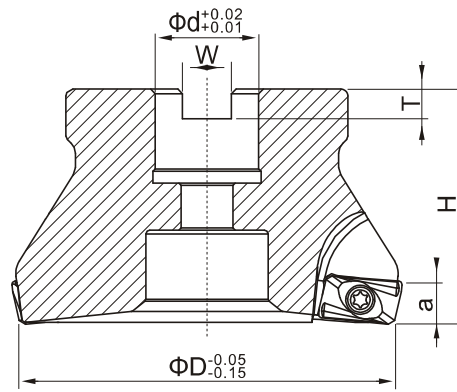

A type

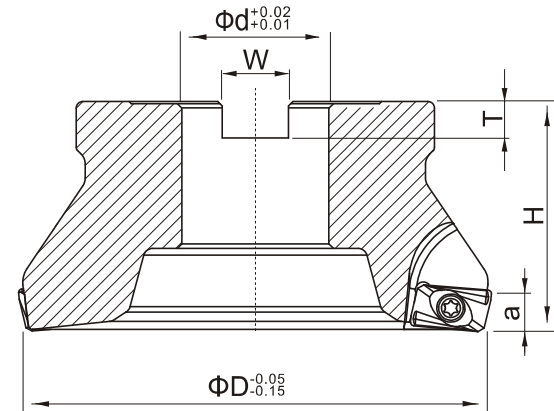

B type

MODEL NO.	Z	type	mm								inserts
			D	d	H	W	T				
RAP400R-63-22	4	A	63	22	50	10.4	6.3	MS4090	T15F T15		APMT1604
RAP400R-80-27	5	A	80	27	50	12.4	7				
RAP400R-100-32	6	B	100	32	50	14.4	8				
RAP400R-125-40	6	B	125	40	63	16.4	9				